

CMT: 16 MARCH 2004
CABINET: 7 APRIL 2004

HANGAR FARM, TOTTON: ADDITIONAL ALLOCATION

1. BACKGROUND

- 1.1 This is a major scheme for the provision of an arts based community building and a new park with recreation facilities. It has been the subject of previous reports to Cabinet in October 2002; April 2003 and September 2003.
- 1.2 At its last consideration, Cabinet agreed the re-allocation of funds between headings but no additional funds were needed at Tender stage. This report however, seeks the allocation of additional funds from developers' contributions following the emergence of additional commitment and extras, during the contracted works.

2. THE REQUIREMENT

- 2.1 The project has an overall budget of just over £3,000,000, of which £1,985,000 is from developers contributions. The additional sum requested totals £200,000. This is a very substantial project with significant ground works over a large area. Officers support the requested allocation as a prudent sum to allocate for the effective completion of the project. There are still some elements that are yet to be fully determined in detail, so it may be that the full allocation will not be needed. On that basis, the recommendation will be to make an allocation "up to" the requested amount.
- 2.2 The demand for additional funding arises from five main elements of the project: upgrade to access and parking (£43,000); removal of additional top soil (£39,000); additional excavation (£30,000); revised planting scheme (£35,000); CCTV (£40,000) and contingency allowance (£13,000).

3. FINANCIAL IMPLICATIONS

- 3.1 The allocated funds from developers' contributions to date stand at £1,985,000, as presented in the report of September last year. The uncommitted fund for open space schemes in Totton is £540,236. The request represents a substantial draw down but this is the principal scheme for the area. The Town Council appreciate the overall position of the fund.

4. ENVIRONMENTAL IMPLICATIONS

- 4.1 An element of the request relates to planting. This is supported as helping to create an environment of a quality and function which is appropriate for a project of this significance to the local community.

5. CRIME AND DISORDER IMPLICATIONS

- 5.1 For the scheme as a whole, these have been presented in earlier reports. The specific issue for this paper is the matter of providing CCTV. There will be a report from the Community Safety Officer to assess the need and any recommendations on specification.

6. CONSULTATION

6.1 This scheme has been the subject of extensive consultation and there has been consistent and strong support throughout its implementation.

7. PORTFOLIO HOLDERS COMMENTS

7.1 The Portfolio holder has supported the scheme from the outset and confirms support for the additional allocation.

8. RECOMMENDATION

8.1 It is recommended that the sum of up to £200,000 be allocated from developers' contributions for open space, to be applied on the basis of the current arrangements for stage payments.

For further information contact:

Martin Devine
Assistant Director of Leisure Services
Tel: (023) 8028 5456
E-mail: martin.devine@nfdc.gov.uk

Background Papers:

Letter from Totton and Eling Town Council
10th March 2003

[j:l:m:cabinet:2004:04:hangeradd]

Hanger Farm Public Open Space and Arts Centre

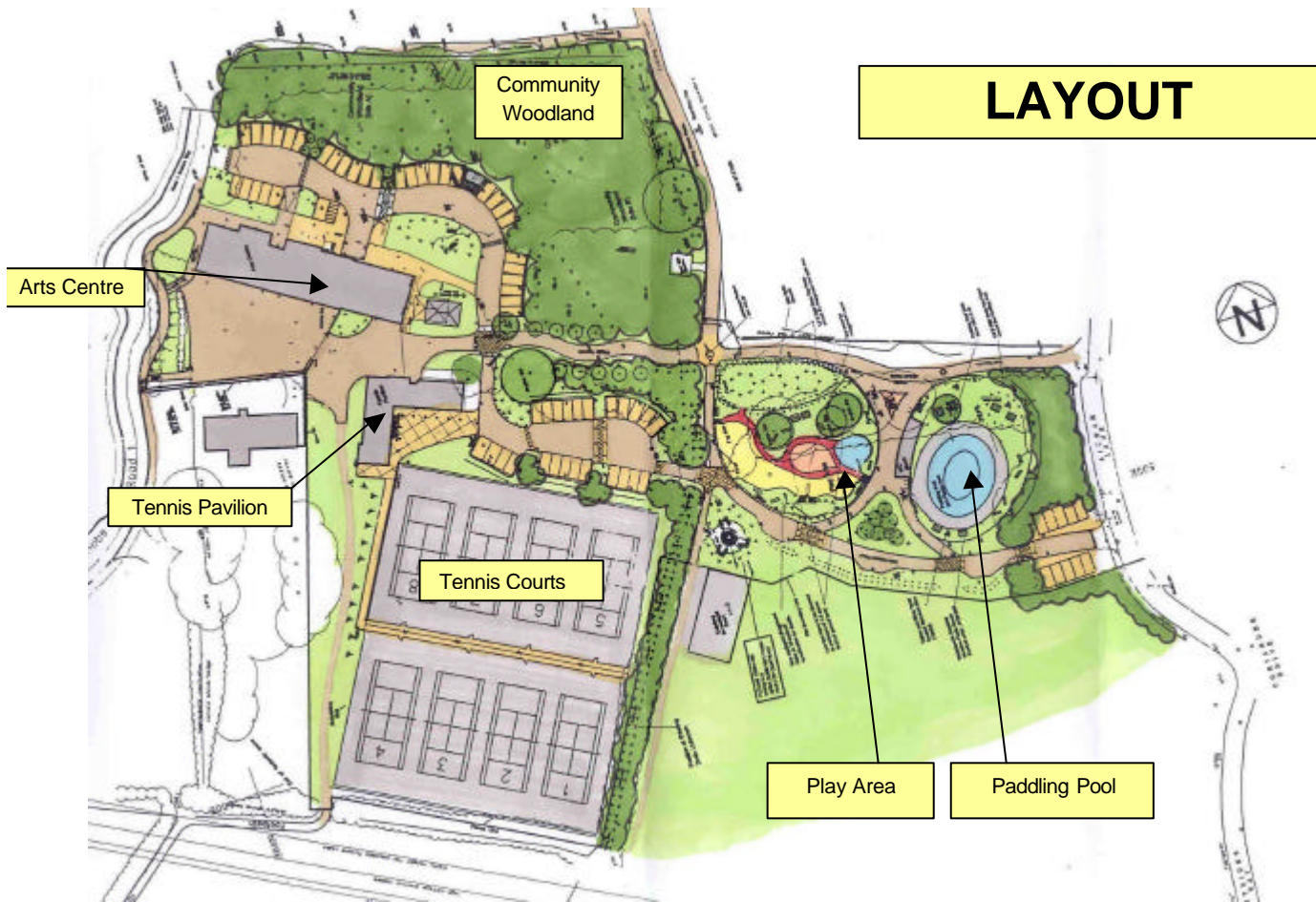

Hanger Farm Public Open Space consists of a parkland setting for a number of community facilities. The historic barn is to be converted into an arts centre. A tennis centre with hard courts and clubhouse facilities, a playground and a paddling pool with public toilets complete the set of formal amenity provision. Community woodland planting, footpaths, cycleways and open space are included for informal recreation, dog-walking etc. The project is one of the last major projects within the network of open spaces that connects up much of the West side of Totton.